

FOR ARCH 2004

15th international building fair

FOR TECH 2004

10th international fair of building machines and mechanization

FOR COMPUTER

7th specialized fair of hardware, software, replacement technology, information systems and technology for designing and building

FOR VERTICAL & FAIR LIFTING

10th international fair of lifts and lifting technology

IDT

Intelligent House & Telecommunications

EMPHASIS THEMES:

- Czech building industry after accession into the EU
- Monuments - their regeneration, renovation and present use
- Technical infrastructure of communities, towns and regions
- Technical infrastructure of houses and apartments, energy savings

FAIR NOMENCLATURE

Legend:

FOR ARCH	- untagged
FOR TECH	- T
FOR COMPUTER	- C
FOR VERTICAL-FAIR LIFTING	- V
IDT	- I

1. BUILDINGS

1.1. PUBLIC SERVICES

Waste services buildings • Water works • Water supply facilities • Engineering buildings • Buildings for power engineering and gas industries • Buildings for the heat supply industry • Transport buildings • Treatments of open areas • Ecological buildings • Forestry buildings

1.2. RESIDENTIAL BUILDINGS AND BUILDINGS FOR SHORT-TERM ACCOMMODATION

Apartment buildings • One family houses • Other buildings for long-term accommodation • Buildings for short-term accommodations • Houses and cottages for recreational purposes • Attic flats and extensions

1.3. PUBLIC BUILDINGS

Administration buildings • Buildings for education, training and research facilities • Buildings for physical education and sports • Buildings for culture and education facilities • Buildings for health service facilities • Buildings for shops and services • Buildings for transport and communication facilities

1.4. BUILDINGS FOR INDUSTRIAL PRODUCTION

Production plants for building materials • Foodstuff production plants • Chemical plants • Textile plants • Engineering plants

1.5. BUILDINGS FOR AGRICULTURAL PRODUCTION

Construction for animal production facilities • Construction for vegetable production facilities • Drainage and irrigation

1.6. BUILDINGS FOR STORAGE

Cooling and freezing facilities • Silos • Tanks

1.7. SMALL BUILDINGS

Mobile WCs

1.8. CONSTRUCTION SITE EQUIPMENT

2. PRODUCTS AND EQUIPMENT FOR BUILDINGS

2.1. FOUNDATIONS AND SUBSTRUCTURE

Earth stability assurance • Substructure insulation • Foundation • Deep foundation • Other parts of substructures

2.2. STRUCTURES

Construction systems • Construction systems • External wall • Internal walls and partitions • Ceiling constructions • Stairs and ramps • Chimneys and shafts • Roofs and roof beams

2.3. COMPLETIONS

Windows • Doors (incl. turnstiles and Security doors) • Equipment for windows and doors • Floors • Completions of roofs • Operation barriers • Railings • Building fittings

2.4. SURFACES

Surfaces of external and internal walls (facing bricks, renders, cladding, foils, paints, sprays, adhesives, reinforcement meshes under cladding) • Suspended ceilings • Floor finishes (incl. carpets, floating floors, paints, adhesives, floor and stair skirtings) • Roof coverings

2.5. TECHNICAL EQUIPMENT OF BUILDINGS

Internal drainage • Water supply piping • Gas supply • Heating • Ventilation, air conditioning • Fixed fire fighting equipment • Refuse removal

2.6. ELECTRICAL INSTALLATION

Electrical equipment (transformers, pylons for power distribution, switchboards) • Components for electrical installation and electrical appliances • Communications equipment

V Transportation equipment • Passenger lifts • Freight lifts • Freight/passenger lifts • Special lifts • Conveyors, travelators, moving pavements • Lifts and platforms for persons with impaired mobility • Ski-tows and funiculars • Components and accessories of lifts • Pneumatic transport

■ Metering, regulation and control • System technology of buildings • Cable systems • Systems for management and administration • System technology of renovation of individual apartments • Lightning rods and earthing

2.7. EQUIPMENT FOR SPACES

Equipment for external spaces (for transportation, for signposting, for external spaces, for children playgrounds) • Saunas and swimming pools • Entrance equipment • Equipment for special purpose spaces • Kitchen fittings including furniture • Equipment for bathrooms and WCs • Laundry equipment • Saunas • Furniture • Small items for flats

2.8. TECHNICAL EQUIPMENT FOR BUILDING SITES

Mechanical equipment for public utilities • Mechanical equipment for public buildings • Mechanical equipment for industrial buildings • Mechanical equipment for agricultural buildings • Mechanical equipment for stores

3. BUILDING MATERIALS

3.1. INORGANIC MATERIALS

Stone and stone products • Concrete and mortar products (mixtures, components of concrete, roof tiles, masonry blocks, pipes, products of light concrete, mortar mixtures, plaster mixtures) • **Fired products** (bricks, ceramic components and slabs, roof tiles, floor and wall tiles, pipes, sanitary ceramics, refractory materials, chemically resistant products) • **Metals and metal products** • **Glass, glass fibres and glass fibre products** • **Mineral wool** • **Gypsum honeycomb panels** • **Non-fired masonry materials** (porous concrete, calcium silicate bricks, gypsum bricks, blocks)

3.2. ORGANIC MATERIALS

Timber and products of wood • Organic and synthetic fibrous materials • Plastics and plastic products • Cork and cork products

3.3. FORMLESS PRODUCTS

Fillers • Binders • Paints • Sealing products, adhesives • Ingredients and admixtures

3.4. INSULATION MATERIALS AND PRODUCTS

Thermal insulating products • Proofing against water and humidity • Sound insulating products • Insulation against vibrations • Special insulation

3.5. OTHER SHAPED PRODUCTS

Fixing and jointing products • Sealing products

3.6. MEDIUMS

Electric energy • Water • Gas • Petroleum • Thermal energy

4. COMPUTER TECHNOLOGY IN BUILDING INDUSTRY

4.1. HARDWARE

4.2. SOFTWARE

CAD systems • Software for technical calculation • Software for budgeting and economic calculation • Graphic information systems

4.3. DATABASES AND INFORMATION SYSTEMS

4.4. INTERNET

General portals • Sector portals • Electronic market places • Internet shops • Services on the Internet • Special applications on the Internet

4.5. REPRODUCTION AND OFFICE TECHNOLOGY

5. TECHNICAL SECTORS

5.1. BUILDING PHYSICS

Building mechanics • Elasticity • Acoustics • Thermal technology • Light • Air flowing • Hydraulics and hydrology

5.2. UTILITY CIVIL ENGINEERING WORK

5.3. BUILDING CONSTRUCTION

5.4. ARCHITECTURE AND URBANISM

5.5. BUILDING GEOLOGY

5.6. GEODESY

5.7. TECHNOLOGY OF CONSTRUCTIONS AND BUILDING WORKS

5.8. ECONOMICS

5.9. BUILDING LAW

6. BUILDING MACHINES, EQUIPMENT, AIDS, APPLIANCES

6.1. BUILDING MACHINERY, EQUIPMENT INCLUDING AIDS FOR:

- for ground works • - for public utilities • - for production, transport and laying of concrete mixes • Tools, hand tools, appliances • Refuse chutes • Shuttering and formwork • Scaffolding • Sheet piles

6.2. TRANSPORT MACHINERY AND EQUIPMENT

Transport facilities • Machinery for moving materials • Building lifts and winches • Working platforms and cradles • Cranes

6.3. OTHER MACHINERY, EQUIPMENT, AIDS AND APPLIANCES

Land measuring equipment, including laser aids

6.4. PROTECTIVE AIDS

6.5. MACHINES FOR THE PRODUCTION OF ENERGIES

Equipment for production of energy on building sites • Machinery for heat productions • Machinery for pressurised air productions

7. BUILDING ACTIVITIES

7.1. BUILDING WORKS - HSV

Earthwork • Laying of pipeline systems • Concrete pouring works • Iron fitting works • Mason's works • Bricklayer's works • Insulation works • Structural strength assurance • Maintenance of humid masonry

7.2. BUILDING WORKS - PSV

Roofer's works • Tinsmith's works • Joiner's works • Blacksmith's and locksmith's works • Glazing works • Treatment surface works • Plumber's works • Electrical installation works • Welding works

7.3. MAINTENANCE, RENOVATION AND MODERNISATION

Maintenance of finished constructions and structures • Facility condition investigation • Renovation of monuments • Renovation of panel buildings

7.4. DEMOLITION

7.5. FOUNDATION OF BUILDINGS

7.6. CONSTRUCTION OF UNDERGROUND FACILITIES

7.7. ENVIRONMENT-FRIENDLY BUILDING TECHNOLOGIES WITH LOW ENERGY DEMANDS

Family houses made of wood • Low energy consumption buildings • Passive buildings • Other construction of sustainable building technologies

8. PROTECTION OF CONSTRUCTIONS AND REQUIREMENTS ON CONSTRUCTIONS

8.1. PROTECTION OF STRUCTURES AGAINST:

effect of chemicals • biological influences • climatic conditions • seismic influences • electrical influences including lightning • explosion hazard • fire hazard • radiation and magnetism

8.2. REQUIREMENTS ON BUILDINGS FROM THE VIEWPOINT:

children • persons handicapped and with defective senses • care for national monuments • protection of the environment • work safety and health protection • high consumption of energy

9. SERVICES

9.1. STATE ADMINISTRATION

Central authorities • District authorities • Local authorities • Municipal authorities • Building authorities

9.2. BUILDING ASSOCIATIONS, UNIONS, CHAMBERS

9.3. BANKS AND SAVING BANKS

9.4. INSURANCE COMPANIES

9.5. STANDARDISATION ACTIVITIES

9.6. RESEARCH AND DEVELOPMENT

Scientific institutes • Laboratories

9.7. ASSESSMENT

Assessment - of designs • Assessment - of constructions • The testing line

9.8. EXPERTS' ACTIVITIES

Court experts • Expert's opinions, audits • Assessment, including real estate

9.9. DIAGNOSTIC ACTIVITIES

9.10. EDUCATIONAL AND INFORMATION ACTIVITIES

Schools • Organisation of conferences and seminars • Organisation of specialised courses and training • Exhibitions • Information activities • Consultation activities

9.11. BUSINESS ACTIVITIES

Wholesale activities • Retail activities • Foreign trade • Representation of foreign firms

9.12. LENDING AND LEASE

Leasing

9.13. MARKETING

Price advisory services • Investigation and marketing research

9.14. REAL ESTATE ACTIVITIES

9.15. GEODETIC ACTIVITIES

Surveying of constructions

9.16. PROJECT DESIGN

Urbanism • Architectonic designs • Designing of renovations • Civil engineering construction designing • Building construction designing • Designing of indoor premises • Structural analysis computations • Budgeting

9.17. SPECIAL WORK

Work in heights • Work of art

9.18. ENGINEERING ACTIVITIES

9.19. DEVELOPER ACTIVITIES

9.20. WASTE PROCESSING

Refuse disposal • Refuse collection • Waste recycling

9.21. TRANSLATORS' ACTIVITIES

9.22. ADVERTISING ACTIVITIES

Promotion materials FOR ARCH 2003

9.23. PUBLISHING ACTIVITIES

9.24. FACILITY MANAGEMENT

1 Prague, September 14th - 18th, 2004 (contractual day - September 14th)
Prague Letňany Exhibition Centre

registration number: _____ date: _____
Closing Date for Binding Applications is March 31, 2004

Commercial name of company _____ Country _____
Address: Street _____ Town _____ AREA CODE _____
Telephone incl. prefix _____ Fax incl. prefix _____
Contact person _____ Telephone _____ Fax _____
Mobile phone _____ e-mail _____ www _____
Director (incl. degree) _____
BIN _____ Bank connection _____
If you want to receive the correspondence concerning your fair participation to another address then this one stated above (i.e. realisation agency), please, state it here.
Commercial name of company _____ Country _____
Address: Street _____ Town _____ PCN _____
Telephone incl. prefix _____ Fax incl. prefix _____
Contact person _____ Telephone _____ Fax _____
Mobile phone _____ e-mail _____ www _____
BIN _____ Bank connection _____

We hereby order the exhibition area at the Fair

FOR ARCH 2004

FOR TECH 2004

FOR COMPUTER 2004

FOR VERTICAL - FAIR LIFTING 2004

IDT 2004

Nomenclature number

Nomenclature number

Nomenclature number

Nomenclature number

Nomenclature number

INDOOR AREA Width _____ m x Depth _____ m (state only whole metres); Total m² _____ check off the area type
(area only, stand see below)

row exposition <input type="checkbox"/>	corner exposition <input type="checkbox"/>	U-shape exposition <input type="checkbox"/>	island exposition <input type="checkbox"/>
Stand depth 1 - 2 m 125 EUR/m ²	9 - 70 m ² 120 EUR/m ²	50 - 120 m ² 122 EUR/m ²	60 - 100 m ² 122 EUR/m ²
Stand depth 3 - 4 m 90 EUR/m ²	more than 71 m ² 100 EUR/m ²	more than 121 m ² 107 EUR/m ²	101 - 220 m ² 113 EUR/m ²
Stand depth 5 m 85 EUR/m ²			more than 220 m ² 94 EUR/m ²

Expositions up to depth 4 meters can not be higher than 250 cm

Surcharge for double-floor part of exposition

50 EUR/m² _____ Figure of m² _____ Stands and expositis heavier than 250 kg/sqm is necessary to claim to the Fair Administration.

For larger or point-type loads, it's necessary to negotiate the reinforcement requirements with the Fair Administration.

Total height of the stand including flaghole will be _____ cm. The dominant above 300 cm of the stand will be _____ cm
(if this data is not given we will assume that an overall height of 250 cm for the whole area of the stand will be sufficient)

The fee for the total height of the stand and the dominant over 300 cm at expositions smaller than 59 m² - 150 EUR
(not related to double floor expositions and one standard)

OUTDOOR AREA width _____ m x depth _____ m (state whole m only); total m² _____
(no stand included) min. area 12 m². The area ordered must be sufficient to include the outer edge of the stand roof

Expositions up to 15 m ²	60 EUR/m ²	Expositions 61 - 120 m ²	47 EUR/m ²
Expositions 16 - 60 m ²	54 EUR/m ²	Expositions exceeding 120 m ²	41 EUR/m ²

After the receiving your Binding Application we will send you a confirmation of its registration and an advance invoice for the area leased. Then you will receive the floor plan of the Fairs (place allocation arrangement) with the marking of the location of your area, the Order Catalogue of Services containing orders of the

The Exhibitor Registration Fee is 120 EUR

We hereby declare that we have made ourselves familiar and agree, without exceptions with ABF, a.s. preconditions for Participation on the FOR ARCH 2003 Fairs, which form an integral part of this Application. We undertake to settle all the advance invoices and the final invoice within their due terms. We take for our information that all prices are given without VAT. We undertake to pay all Advance Invoices and also the Final Invoice.

place, date _____

stamp, signature _____

Note: The application is only valid when the place, date, stamp and signature are given.

ARTICLE I. - PARTICIPATION IN THE FAIRS AND ASSIGNMENT OF AREAS

The basic precondition for the participation in the Fair is the delivery of the properly completed Binding Application to ABF, a.s. (hereinafter referred to as ABF only) by the closing date and the payment of the advance for the required area within the due term stated in the invoice. After the receiving of the Binding Application ABF will send to the Exhibitor a confirmation about its receiving (herewith contractual relation will come into being) an advance invoice for the ordered area and a registration fee for the exhibiting company for the amount:

a/ - in the case of Applications evidently delivered to ABF by mail or personally by March of 31, 2004 inclusive - 60 % of the price of lease for the ordered area and Exhibitor's Registration Fee in full amount. The Exhibitor will only be registered when the advance payment is evidently on the ABF's account. The remaining part of the area lease amounting to 40% of the total price is due for payment in June 2004 on the basis of an invoice issued.

b/ - in the case of Applications evidently delivered to ABF after April of 1, 2004 inclusive - 100 % of the price of lease for the ordered area and Exhibitor's Registration Fee.

The Exhibitors who have paid for the preliminary reservation by January 9, 2004 (date of payment is to be understood as the date when the amount has appeared on the ABF's account) will receive the invoice for the remaining part of the payment for the area in June 2004. After a final elaboration of applications and after the settlement of invoices the exhibitor will receive the floor plan with the location of his area. **ABF reserves the right to reduce the ordered area, to change its shape and location - the order of the participation is binding for the Exhibitor also in this case.**

The advance invoice for the ordered services will be sent before the beginning of the Fair and its full payment will be a precondition for the beginning of the assembly of the exposition. The final invoice and deduction of advances will only be sent after the finishing of the Fair.

If the Exhibitor fails to settle the charges for the area lease and/or the Exhibitor's Registration Fee in full amount and due term, ABF will confirm the allocation of the area lease to another applicant without the original Applicant being allowed to claim ABF for possible expenditures incurred.

If the confirmed area is not available to the Exhibitor for reasons caused by the Organizer of the Fair, the Exhibitor is entitled to the reimbursement of the lease charge paid. The Organizer will not accept and will not indemnify any claims for damages which the Exhibitor could have incurred for this reason.

ARTICLE II. - TERMS OF PAYMENT

All prices are mentioned without VAT.

Basic price of the lease and Registration Fee includes:

- Lease for the area during the assembly, Fairs and dismantling
- Insertion into the Fair Catalogue to the extent of data stated in the Order of Registration into the Catalogue
- Insertion into the orientation system of the Fairs
- Five Exhibitor's Cards for the firms with an ordered area up to 30 m²
- One Exhibitor's Card for each 10 m² (including a part of this area) exceeding the area of 30 m²
- Assembly/Dismantling Cards for the Working Teams
- Cards for free entries into the area during the assembly and dismantling works (during the assembly and disassembly the parking time in the area is limited - the entry is committed on the deposit settlement)
- One issue of Fair Catalogue
- Free registration at the Building Information System
- Invitation for the common party for 2 persons

Basic price of the lease and registration fee does not include:

- External walls of the stand, nor any other equipment of the stand, nor the walls of the neighbouring stands.

For each the other firm, which the Exhibitors will present in their expositions (by the presentation of exhibits, with an advertisement panel, company logo, commercial name, folders, video programmes, etc.), the Exhibitor is obliged to pay the Co-exhibitor's Registration Fee. The firm properly registered in this way will be presented in the Fair Catalogue to the full extent as Exhibitor. **In the case of any breach of this principle the Exhibitor will be obliged to pay the Co-exhibitor's registration Fee in a double amount during the Fairs.**

Cancellation Conditions

ABF will keep the below stated percentages of the price of fulfilment, depending on the term of the cancellation of the Binding Application:

20 % on the cancellation of the Binding Application

in the term from April 10 to April 30, 2004 inclusive

40 % on the cancellation of the Binding Application

in the term from May 1 to June 30, 2004 inclusive

80 % on the cancellation of the Binding Application

in the term from July 1 to July 31, 2004 inclusive

100% on the cancellation of the Binding Application

in the term August 1, 2004 to the beginning of the Fairs

To the company that Binding application of the participation was delivered to ABF the engagement of cancellation payment (100%) arises though the company did not pay nor advanced nor any other invoice.

The cancellation of the participation must always have the written form.

Registration Fees shall not be returned, nor any part thereof, regardless to the term of the cancellation of the Binding Application or with no participation without cancellation.

ARTICLE III. - EXHIBITION AREA

ABF leases:

- indoor exhibition area without any equipment, with the possibility of power supply, water pipeline, sewerage, telephone and cleaning facilities on the basis of the Application. Minimum depth of the expositions is **3 m**. Minimum sizes of the exhibition areas are stated in the Binding Application for the Participation of the firm. **Expositions up to depth 4 meters can not be higher than 250 cm**

- outdoor exhibition area on the defined open areas of the Exhibition Centre. Minimum area of the expositions situated on the outdoor area is 4 x 3 m, i.e. 12 m², or, **respectively, 20 m² (with roof over the stand).**

If the exhibiting firm itself does not provide for the stand or if it does not order its erection by ABF, it will have only the ordered exhibition area without borders at its disposal. The architectural concept in the exhibition halls counts on the implementation of the classical rectangle exhibition floorplan, within which the following exhibition areas will be available:

- row areas with free front side
- corner areas with two open sides - along which the visitors walk
- U-shape areas (front) with three open sides - along which the visitors walk
- inland areas where all of the four sides are open.

ARTICLE IV. - SAFETY AND INSURANCE

The Exhibitors are not allowed to store or use in their expositions or in the territory of the Exhibition Centre any combustible and radioactive substances, exploding materials, acids, poisons and other health harming substances. The Exhibitors are obliged to observe the technical, fire and safety regulations which are in force.

At the Exhibition Centre ABF is not responsible towards the Exhibitors, their Co-exhibitors and assembly firms for any losses, destruction or any damage concerning the exhibits, equipment and outfit of the stands, goods, packages, packing materials whatsoever, whether the loss, destruction or other damage occurred during the assembly, transportation or during the Fairs. Therefore the Exhibitors and assembly firms are obliged to have all the exhibitions and above mentioned materials insured, it applies to the Exhibitors' own materials as well as to those belonging to their Co-exhibitors and for the entire period of their presence at the Exhibition Centre, such an insurance being made against any danger that can be considered in the connection with the Exhibitors' property.

ARTICLE V. - TECHNICAL AND FIRE REGULATIONS, ENERGY USAGE REGULATIONS AND DIRECTIVE FOR THE USE OF TEMPORARY INSTALLATIONS

During the time of the Fairs as well as during the assembly and dismantling works **smoking and naked flame handling is prohibited** in all of the indoor areas.

The Exhibitors are obliged to observe, during the assembly, in the course of the Fairs and during the dismantling, law regulations of the Czech Republic and technical standards for the above mentioned areas including work safety regulations and handling all technical equipment. Furthermore, the Exhibitors are obliged to observe appropriate fire regulations valid for individual exhibition areas and the instructions of the authorised members of the fire assistant service and of the ABF staff. Temporary electrical devices must be in accordance with the ČSN 341090 standard and must comply with all other electro technical regulations in force. The electrical installation works can only be carried out by a firm duly authorised to do so, i.e. possessing the Certificate of Competence according to the Law No. 174/1968 Coll., §4 part f and §3 part 2 of the - ČUBP No. 20/1979 Coll.

ARTICLE VI. - BASIC CONDITIONS FOR THE ERECTION OF THE STAND

The erection of the Stand is offered and realized by ABF. The Exhibitors who will not make any use of this offer and who prefer to ensure the erections of their stands by themselves or through their agencies are **obliged to put forward the ground plan and front view of the stand with the marking of dominant heights for approval to be given by ABF, not later than July 23, 2004** and to announce the name of the implementation firm. **The Exhibitors are obliged to maintain the floor plan of the exhibition area, i.e. they may not exceed the designated area with anything from the ground plan point of view and the same applies to the dominant heights which are shifted out (Attention! - the roofs of outdoor stands generally exceed their ground plan).**

The Exhibitors are obliged to leave the exhibition area after the dismantling in the same conditions in which it was before the beginning of the assembly. Any destruction, exceeding pollution etc., will have to be paid for by the Exhibitor according to the real cost of the removal of damage (pollution).

ARTICLE VII. - FINAL PROVISION

All complaints on the part of Exhibitors towards ABF during the assembly and in the course of the Fairs shall be produced in written form to the Director of the Trade Fair Administration of ABF or to an authorised representative before the end of the Fairs, or during the dismantling works until they are completed.

Any other claims on the part of Exhibitors towards ABF can be applied for within two (2) weeks after the end of the Fairs. All possible claims of the Exhibitors will cease to exist upon the expiration of 6 months after the end of the Fairs.

Article VIII. - CLOSING DATE for Applications and Orders

The Binding Application, the Binding Order of Technical Services, the Order of Registration of Other Firms - Co-exhibitors and the Order of Additional Records into the Catalogue shall be sent to the address: ABF, a.s. Veletržní správa (Trade Fair Administration), Václavské nám. 29, 111 21 Praha 1, Czech Republic **till March of 31, 2004** - we recommend that all correspondence to be sent by **registered mail**.

2

Commercial Name of the Firm _____

All services which are not marked will be automatically considered as **NOT ORDERED**.

INDOOR AREA

Order for electrical power supply during the fair - mark with below:

supply 230 V - L + N + PE

to 2 kW - 1 socket to 3 kW - 1 socket
 120 EUR 150 EUR

supply 400 V - 3L + N + PE

to 5 kW - 2 sockets to 6 kW - 2 sockets to 9 kW - sock. 16 A to 15 kW - sock. 32 A to 21 kW - sock. 32 A to 40 kW - sock. 63 A
 195 EUR 220 EUR 285 EUR 405 EUR 485 EUR 900 EUR

Higher voltages of el. input is charged by the amount of 20 EUR for each kW above 42 kW and must be individually negotiated

Refrigerator circuit - 25 EUR

(price does not include power consumption) Number of circuits _____

Water supply order

connection and drainage

price does not include lease of sink

number of branches _____ each 240 EUR

Phone order

price does not include cost of calls

number of branches _____ each 120 EUR

Exhibition area cleaning

cleaning daily

number of m² _____ 0,5 EUR/ m²/day

Internet

120 EUR each

number of connections _____

OUTDOOR AREA

Order for electrical power supply during the fair - mark with below:

supply 230 V - L + N + PE

to 2 kW - 1 socket to 3 kW - 1 socket
 130 EUR 165 EUR

supply 400 V - 3L + N + PE

to 5 kW - 2 sockets to 6 kW - 2 sockets to 9 kW - sock. 16 A to 15 kW - sock. 32 A to 21 kW - sock. 32 A to 40 kW - sock. 63 A
 215 EUR 245 EUR 310 EUR 440 EUR 535 EUR 990 EUR

Higher voltages of el. input is charged by the amount of 22 EUR for each kW above 42 kW and must be individually negotiated:

Refrigerator circuit - 30 EUR

(price does not include the power consumption) Number of circuits _____

Water supply order

connection and drainage

price does not include lease of sink

number of branches _____ each 240 EUR

Phone order

price does not include cost of calls

number of branches _____ each 210 EUR

Exhibition area cleaning

cleaning daily

number of m² _____ 0,5 EUR/ m²/day

Internet

120 EUR each

number of connections _____

The revision of electroinstalation will be entirely practiced by the electrician of ABF, a.s. under the fee 14 EUR

We hereby declare that we have made ourselves familiar and agree without reservations with the ABF Technical Preconditions of the Participation in the group of the Fairs FOR ARCH 2004, which form an integral part of the Binding Application. We undertake to pay all of the advance invoices and the final invoice in due terms.

place, date _____

stamp, signature _____

Note: The application is only valid when the place, date, stamp and signature are given.

ARTICLE I. - TIME DATA

The Fairs will start on September 14, 2004 and end on September 18, 2004, the contractual day is on September 14, 2004.

The assembly and dismantling instructions will be sent during August 2004.

For the public the Fairs will be open: Tuesday - Friday from 10 a.m. to 6 p.m.
Saturday from 10 a.m. to 4 p.m.

ARTICLE II. - EXHIBITION AREA

ABF leases:

- indoor exhibition area without equipment with the options of the inlet of power supply, water and sewerage lines, telephone and cleaning services on the basis of orders. **The minimum depth of the expositions is 3 m.** The minimum sizes of the exhibition areas are mentioned in the Binding Application, on page Participation of the Firm.

- outdoor exhibition area in the designated open areas of the Exhibition Centre. The minimum sizes of the exposition on the outdoor area is 4 x 3 m, i.e. 12 m² or 20 m² (roof over the stand), respectively.

Height of halls, floor load

It makes it possible for a limited number of expositions to erect double-floor stands as well as dominant heights. The effective height varies from 3.0 to 8.0 m. Maximum height of an exhibit for transportation to the halls is 3 m. Basic load capacity of floors is 250 kg/m².

On an extra order in the Binding Application it is possible to ensure individually the reinforcement of the floor up to a load capacity of 750 kg/m². Maximum weight of an exhibit is 2.5 t.

ARTICLE III. - TECHNICAL SERVICES

On the Exhibitor's order it is possible to provide the inlet of power supply, water and sewerage, telephone and cleaning services (once a day vacuum-cleaning and emptying of the waste basket) to all expositions in both indoor and outdoor areas.

The advance invoice for the ordered services will be sent before the beginning of the Fairs and its settlement will be a necessary condition for the beginning of the assembly of the exposition. The final invoice will be sent after the finishing of the Fair.

Order of power supply

For the stands, which are not ordered to build by ABF, your own switchboard is presupposed - it should be adapted to the 5-wire distribution system, or the voltage system TNS 3L + N + PE, 50 Hz, respectively. Single-phase connection of the exposition is carried out through a usual plug of 220V/16A - L + N + PE, three-phase consumers must be fitted with a recommended ball plug of 400V/32 A - 3L + N + PE. The connection of larger power inputs will be carried out upon an agreement with ABF. Electrical equipment of Exhibitors which is not fitted with separate operation N and protecting PE (zero) wires, or which is not fitted with a protecting wire, without its featuring double insulation, or the wires of which do not have appropriate section, will not be allowed for the reason of the protection of visitors from electric accidents and for fire reasons. In the case of necessity it is possible to use the work of an electrician at a price of 12EUR per hour (each hour started is taken into account), which is to be paid immediately at the cash desk of the Trade Fair Administration.

Electric inspection is carried out by ABF and it is OBLIGATORY. Its price is not included in the price for electrical inlet. If the electrical installation does not comply with the requirements, it will not be connected, to the prejudice of the Exhibitor.

We ask the Exhibitors to consider their real demands for the power supply input. For the purpose of a more exact order we provide the following examples: the illumination of a 9 m² stand about 0.5 kW, refrigerator 0.4 kW, kitchen complete set about 3.5 kW, coffee machine about 0.8 - 1.2 kW, fast water heating unit about 2 kW, two hot-plate cooker about 2 kW. These power inputs are only for your orientation - it always depends on the particular electrical appliance which is connected.

CAUTION! In the case you intend to use a refrigerator in your stand, we recommend to order the refrigerator circuit separately, as it will not be turned off overnight.

Order of water and sewerage

The interconnection of the sink, i.e. of an ordinary battery to the closing valve and of an ordinary siphon outlet with a 5/41 hose is included in the price of the water inlet and sewerage. **The lease of the sink is not included in the price for water inlet and sewerage.** If you want to make a wider use of the plumber's service, you will be charged EUR 12 per hour (each hour started is taken into consideration) and you will pay this service at the cash desk of the Trade Fair Administration.

Extra costs caused by placing the connecting point in a distance longer than 10m from a technical canal will be charged individually.

Internet connection

In halls 1,2,3, and 7 is realized by connection to local network ETHERNET 10/100MB. Computers of exhibitors have to be equip by net card ETHERNET 10/100MB with possibility of connection to connector RJ-45. For a connection to network is necessary to adjust IP addresses from DHCP server. To obtain fixed addresses will be possible only for extra charge and after negotiations with techniques of ABF. The exhibitor in this case will not pay any further telecommunication fees.

Halls 4,6 and outdoor areas are provided through analogue modem with max. 33,3 kB/s. Exhibitors PC must be equipped by regular modem (not ISDN). On exhibition area will be outlet of telephone network. Adjustment of PC will be provided by technical staff of Exhibition Centre. The exhibitor in this case will not pay any further telecommunication fees.

Daily cleaning

Daily cleaning embraced vacuum cleaning of the stand carpet once a day and taking out the garbage can after finishing of the exhibiting day, it means in evening hours; or if the exhibitor has especial request in morning hours before the exhibition will be open. Any supplementary requests above mentioned frame will be accounted besides.

Technology of carpets affixing in halls 1,2, and 7:

For spreading of carpets to expositions in halls 1,2,7 it is necessary to observe the following process: **On the concrete floor to stick a first a masking - paper tape and successively an arbitrary reversible carpet tape.** Masking tape can be bought directly at the exhibition ground. After the end of an assembly term the exhibitor is obliged to pass on a quite empty and clear area in the same condition in which he has received it. In the case of a damaging or soiling the exhibition area the exhibitor is obliged to settle the damage in a full amount.

Other services

ABF will arrange: working illumination, fire service, ordinary cleaning of communications, dispatching and customs services, health service, insurance service, telephone and fax centre for the Exhibitors, Press centre service, business centre, the Fair Protocol and catering facilities.

ARTICLE IV. - ERECTION OF STAND - EXPOSITION

ABF will ensure the erection of stand in both indoor and outdoor areas on the basis of a separate order distributed by ABF together with the Binding Application.

ARTICLE V. - TECHNICAL AND OPERATING CONDITIONS

-The architectural realisation and the operation of the exposition must not disturb or limit other expositions.

-The outline of the exhibition stands must not exceed the outline of the leased exhibition area, which applies to the space above the ceiling structure of the stand as well.

-Possible overhang of the collar or eye-catcher of the stand to the path is allowed on the basis of a preliminary approval given by ABF, if the minimum height of the bottom edge is 3 m, and it will be subject to the payment of 50EUR

-In the case of expositions smaller than 59 m² incl. the dominant height exceeding 3 metres will be subject to payment (it does not concern the double-floor expositions and flag poles).

-Except for handling trucks, entry into the exhibition areas is prohibited for any means of transport and cars.

-If the floor of the hall is damaged, the Exhibitor will be obliged to reimburse the damages to the full amount.

-Smoking and naked flame handling is strictly prohibited in all indoor exhibition areas, any breach of this ban will result in a fine paid on site.

-No electrical appliances may be left in operation without any control. When leaving the place, the appliances must be disconnected from the mains.

-It is **not allowed** to hang any eye-catchers, flags, etc. on the structure of the halls with the exception of the cases pre-discussed with ABF and subject to a payment.

-During the assembly it is forbidden to cut and grind any building elements, which causes excessive pollution and dust (plasterboard, tile materials, fibreboard and other similar materials).

-The stand must not touch the structure, walls and roof of the exhibition halls with any of its parts. The distance between the highest point of the stand and the hall roof must be at least 70 cm.

-It is forbidden to discharge the remains of paints and other toxic substances which could pollute or otherwise endanger the environment into the sewerage, sinks and basins. The Exhibitors or the firms authorised by the Exhibitors are obliged to take these substances away and ensure their disposal on their own expenses.

-During the Fairs it is permitted to perform audio-visual, acoustic, musical, dancing and other productions for the time not exceeding 8 minutes once an hour, and only provided that the other Exhibitors will not be disturbed by the operation of these facilities. If this condition is breached, the Exhibitor will have to pay a fine amounting to 160EUR and in the case of repeated breach it will be forbidden for the breaching Exhibitor to operate all such productions.

-The exhibits which will be presented in the operation can only be serviced by the persons authorised thereto. Presented exhibits must be secured by the Exhibitor in such a way that no third party could handle them wilfully.

-Except for the prescribed working business hours of the Fairs and permitted time interval for the supplying of the stands it is forbidden to stay in the exhibition areas. Please, respect for this reason the instructions of the Security Service and the ABF staff.

-By the deadline of disassembly works the Exhibitor or his assembly company is obliged to hand over the leased exhibition area empty and in the conditions in which it was taken over, i.e. also the floor covering (carpets, PVC) must be removed as well as the sticking carpet tapes, such a removal being carried out at the expenses of the Exhibitors. Should the exhibition area be damaged (by boring, cutting, breaking, excessive polluting, etc.), the Exhibitor will be obliged to reimburse the damages in full.

-If the deadline for the clearing of the exhibition area fails to be observed, a penalty amounting to 160EUR per m² of the non-cleared area will be charged. In the necessary case the exposition will be cleared by ABF at the expense of the Exhibitor. The risks associated with the clearing shall be borne by the Exhibitor.

-The placement of billboards, eye-catchers, banners as well as the distribution of printed and other materials out of the stand area is permitted only for consideration after prior negotiations with the ABF Trade Fair Administration in writing.

ARTICLE VI. - HANDING OVER OF THE BACKGROUNDS FOR THE REALISATION OF TECHNICAL CONNECTIONS AND STANDS

The Exhibitors who order the erection of the stand with ABF will send their orders within the term provided for in the Order of the stand. Any changes relating to the Order of Technical Services, construction and equipment of stands required by the Exhibitor additionally after the term of commencement of the assembly will only be managed after the fulfilment of the properly ordered work and services towards the other Exhibitors. These additional orders of work and services can be charged by ABF with a surcharge amounting to as much as 100% of the price calculated. The payment shall be made by the Exhibitor in cash on site.

The Exhibitors who ensure the erection of the stand on their own or through an advertising or realisation agency will send to ABF and within the term provided for in the Order Catalogue of Services **the design of the stand for approval** (in the front view and ground plan) where all possible dominant heights and eye-catchers, including the stand orientation within the framework of the ordered area will be drawn by means of **the location dimensioning of the inlets of power supply, water and sewerage including the name of the realisation firm. It is requirement to have a static appraisal for a erection of double floors stands!** In the case that the Exhibitors fail to send appropriate backgrounds within the requested terms, they will expose themselves to the danger of possible difficulties during the realisation of the stands and possibly to additional costs connected with the displacement of the inlets of power supply, water and sewerage.

3

FREE OF CHARGE

p - project
 r - realization
 o - business without own manufacturing, sale
 v - manufacture
 d - importer
 j - others

Company _____ Country _____

Address: Street _____ Town _____ Post code _____

Phone incl. country code _____ Fax _____

e-mail _____ internet (www) _____

Brief description of the exhibits or services on offer maximum 240 characters:

The text in English to be presented in the Catalogue (maximum 240 characters):

The data above will be presented free of charge in the Catalogue and in the information system (signage). Please give the name of the firm exactly as you want it to be published in the Catalogue. The first letter must correspond to the letter under which you want the firm to be indexed. The text is subject to editing by ABF.

We request that the Catalogue should include an entry for our firm with the following contact addresses (without description of exhibits) for our branches, (or divisions, commercial representatives etc.), and we agree to pay the fee of 20 EUR for each address: Number of additional addresses for the Catalogue: _____ (if necessary please copy the form)

1.

Branch name _____

Address: Street _____ Town _____ Post code _____ Country _____

Telephone incl. country code _____ Fax incl. country code _____

e-mail _____ internet (www) _____

2.

Branch name _____

Address: Street _____ Town _____ Post code _____ Country _____

Telephone incl. country code _____ Fax incl. country code _____

e-mail _____ internet (www) _____

3.

Branch name _____

Address: Street _____ Town _____ Post code _____ Country _____

Telephone incl. country code _____ Fax incl. country code _____

e-mail _____ internet (www) _____

place, date _____

stamp, signature _____

Note: The application is only valid when the place, date, stamp and signature are given.

4

Co-exhibitor is the company which is during the fair presented by its company name, logo, panel, advertising objects, person presenting another company etc.

Main Exhibitor _____

We hereby declare that the following firms (our co-exhibitors) will also be presented on our exhibition area. We will pay the registration fee of EUR 120 for each firm and ask that they should be included in the Catalogue.

Number of co-exhibiting firms _____ (if necessary, please, copy the form)

1.

Co-exhibitor _____

Address: Street _____ Town _____ Post code _____ Country _____

Telephone incl. country code _____ Fax incl. country code _____

e-mail _____ internet (www) _____

Characteristics of the exhibits or services on offer maximum 240 characters:

The text in English to be presented in the Catalogue (maximum 240 characters):

The data above will be presented free of charge in the Catalogue and in the information system (signage) exactly as you write it. Please give the name of the firm exactly as you want it to be published in the Catalogue. The first letter must correspond to the letter under which you want the firm to be indexed. The text is subject to editing by ABF.

Contact person _____ Telephone incl. country code _____

fax _____ mobile phone _____ Co. Regn No. _____

2.

Co-exhibitor _____

Address: Street _____ Town _____ Post code _____ Country _____

Telephone incl. country code _____ Fax incl. country code _____

e-mail _____ internet (www) _____

Characteristics of the exhibits or services on offer maximum 240 characters:

The text in English to be presented in the Catalogue (maximum 240 characters):

The data above will be presented free of charge in the Catalogue and in the information system (signage) exactly as you write it. Please give the name of the firm exactly as you want it to be published in the Catalogue. The first letter must correspond to the letter under which you want the firm to be indexed. The text is subject to editing by ABF.

Contact person _____ Telephone incl. country code _____

fax _____ mobile phone _____ Co. Regn No. _____

place, date _____

stamp, signature _____

Note: The application is only valid when the place, date, stamp and signature are given

5

**Competition for 10 GRAND PRIX
and max. the same number of Honourable Mentions.**

for internal use only registration number: _____ date _____

Please, send the above mentioned documentation together with the Application for the Participation in the Competition **by June 30, 2004** The supplementary applications will be accepted on the basis of preliminary negotiation by July 31, 2004.

1.
 Commercial name of firm _____
 Title _____
 Producer _____
 Description of exhibit _____

 Characteristics of the properties for which we declare the product to the Competition _____

2.
 Commercial name of firm _____
 Title _____
 Producer _____
 Description of exhibit _____

 Characteristics of the properties for which we declare the product to the Competition _____

3.
 Commercial name of firm _____
 Title _____
 Producer _____
 Description of exhibit _____

 Characteristics of the properties for which we declare the product to the Competition _____

place, date _____ stamp, signature _____

**Note: Without your stating the place, date, stamp and signature the application is not valid
The documentation and samples will not be returned if not explicitly requested**

There are evaluated the exhibits, which bring progress in the production base of building engineering and architecture or in the construction technology. The exhibits should be comparable by their parameters with a world level or should govern the trend of development in the branch.

ABF, a.s. is enunciator of the competition.

The exhibits will be shown on the trade fair FOR ARCH organized by ABF a.s. in the Prague exhibition area.

The basic criterion's:

Technical solution, non-traditional idea, extraordinary quality for acceptable price, ecological viewpoints, chemical and biological non-obnoxiousness, energy saving and the general properties characterising the provident relationship to the environment.

The sale or dealer organisation which would exhibit on the trade fair is allowed to register the product for the competition on behalf of the producer, when he agrees.

GRAND PRIX can be awarded only once to any exhibit during the International building trade fairs FOR ARCH.

The jury consists of specialists working in the appropriate branch. The jury members and the chairman are independent personnel's, they are not employed in the organising company of the trade fair.

Exhibitor will deliver for purpose of evaluation the documentation, which characterises in sufficient extent the exhibit in Czech language (technical graphical image, technical parameters, certificate, protocol of test, announcement about the congruity - see Law about the technical requirements for products - Law 22/Sb. 1997.

Jury is entitled to request additional information about the evaluated exhibit in process of evaluation, not only from the exhibitor but also from the other sources. The jury governs independently the way of evaluation and seriousness of the individual affordable information about the exhibit registered.

Jury awards at maximum 10 GRAND PRIX and the same amount of the honourable appreciation.

The course of the jury evaluation it is not a public issue and also is not possible any abjuration against verdict.

The exhibitor is obliged to pay the registration fee in amount of EUR 165 for each registered exhibit, against the invoice issued by ABF.

The basic criterion's of evaluation

The jury evaluates the parameters of products in advance, on basis of the handed over documentation (attests, certificates, catalogue sheet, prospects, branch documentation, price list etc.). Directly on the fair, there is verified fulfilling the criterion's and the visual characteristic of the exhibits from the shortlist of the former selection.

The professional jury presents the list of exhibits proposed for the appreciation to the enunciator of the competition for the approval.

Enunciator of the competition is not obligated to rationalise the jury verdict. There is not any abjuration against the jury verdict.

The results of competition will be officially presented on the ceremonial evening.

The registered exhibits will be marked in expositions after the fair opening. The exhibits awarded will marked immediately after announcing the results of competition.

The list of the registered exhibits will be presented in the Fair Catalogue Guide, Catalogue of the Exhibition, in periodicals Stavební listy and Forum architektury a stavitelství and also on internet pages www.forarch.cz, www.abf.cz

Enunciator reserves the right to react on the technical and organisational issues, which could lead to changes in time terms or course of the competition. To the all registered sides there is guaranteed the timeous information.

The closing day of the application form for GRAND PRIX competition is June 30, 2004

ATTENTION! THE SERVICE FOR EXHIBITING FIRMS!



When arranging the exposition we would provide you with a technical consultation made by experienced professional, featuring the long-time praxis in exhibitions. The exposition itself would be solved on base of your requests to emphasise the image of the firm.

The individual approach and the flexibility from our side, it is a precondition of the mutual co-operation.

As a part of this offer, it is also a free of charge consulting activity about the form of the trade fair presentation.

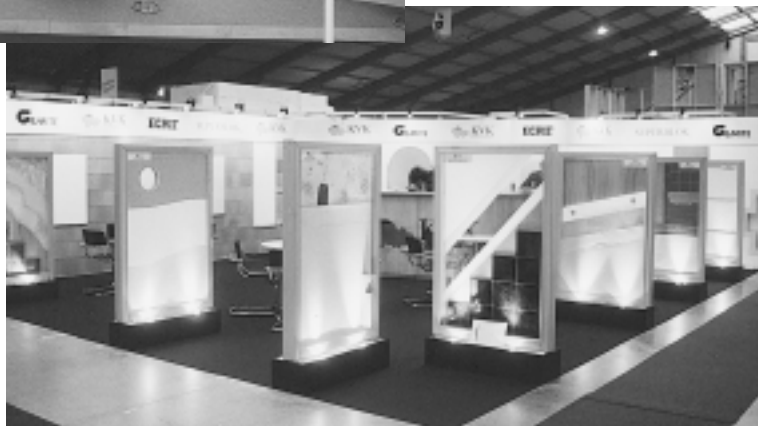

For setting the price for stand manufacturing, it would be decisive the laboriousness when making it, amount and sort of the material used, extent of services of architect and the reproducibility of the exposition.

For the reproducible exposition we offer the price reductions. The FOR ARCH trade fair need not be the first one, on which would appear the exposition arisen from the mutual co-operation between you firm and ABF.

If you are interested in realization and architectonic solution of the atypical stand through ABF, a.s., contact us immediately.

ABF, a.s.
Veletržní správa

Correspondence: Václavské nám. 29
111 21 Praha 1
Czech Republic

Administration office: Mimoňská 645
Praha 9 - Prosek
Phone: +420 222 891 130-1
+420 222 891 115
Fax: +420 222 891 199
e-mail: vyjidak@abf.cz

6

Order of standardised stands for the covered area

It's price contains:

- circumferential walls of white panels and partition walls of small store rooms
- ceiling raster
- carpet - grey
- collar for the identification of exposition - height 30 cm (according to the length of the front side)
- 2 to 6 point lighting fittings according to the stand size (without power supply inlet)
- 2 power sockets for 220 V (without power supply inlet)
- Store room of the area 9m² in teh arrangement 1 x 1 m with a cupboard (without power supply inlet)
- store room of the area of at least 12 m² in the arrangement of 1 x 2 m with a cupboard with shelves, door and 1 ceiling fitting (without power supply inlet)
- store room of the area of at least 18 m² in the arrangement of 2 x 2 m with a cupboard with shelves, door and 1 ceiling fitting (without power supply inlet)

The ground plans of the standardised stands are specified on the reverse of this sheet.

It is not possible to change or add anything to the basic equipment of standardised stands, it is, however, possible to order movables and other equipment.

Sizes and prices of standardised stands of type

Type A	3 x 3 m	price	EUR	255.-
Type B	3 x 4 m	price	EUR	345.-
Type C	3 x 5 m	price	EUR	425.-
Type D	4 x 4 m	price	EUR	455.-
Type E	5 x 5 m	price	EUR	700.-
Type F	4 x 6 m	price	EUR	695.-
Type G	4 x 5 m	price	EUR	570.-
Type H	3 x 6 m	price	EUR	505.-

Company: _____

Hall no. _____ Sector _____ Stand no. _____

We definitely order the realisation of the standardised stand of type:

We require that the stand should be equipped with movables

In the case of YES, please fill in: **Order of movables and other equipment.**

place, date _____

_____ stamp, signature

Closing date for orders is July 31, 2004

Note: The order is not valid unless the place, date, seal and signature are filled in

Standardised stands contain:

- circumferential walls of white panels and partition walls of small store rooms ● ceiling raster ● carpet - grey ● shield for the identification of exposition (on the front side) - height 30 cm ● 2 to 6 point lighting fittings according to the stand size (without power supply inlet) ● 2 power sockets for 220 V (without power supply inlet) ● store room of the area of at least 9 m² in the arrangement of 1 x 1 m with cupboard with shelves and door (without power supply inlet) ● store room of the area of at least 12 m² in the arrangement of 1 x 2 m with a cupboard with shelves, door and 1 ceiling fitting (without power supply inlet) ● store room of the area of at least 18 m² in the arrangement of 2 x 2 m with a cupboard with shelves, door and 1 ceiling fitting (without power supply inlet)

typ A

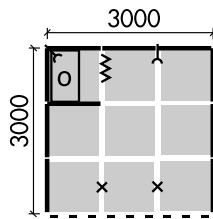

typ B

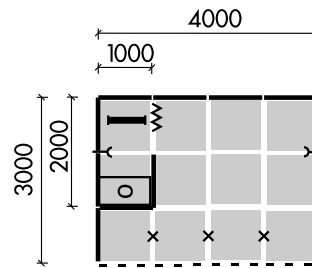

typ C

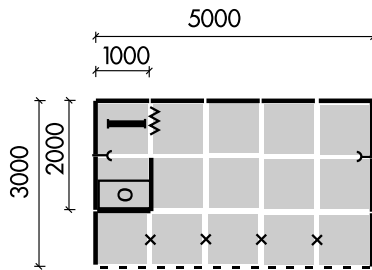

typ D

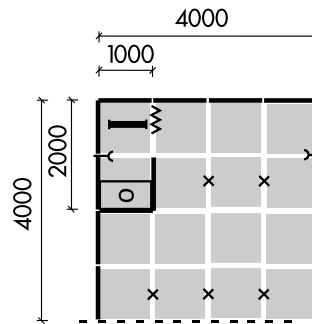

typ E

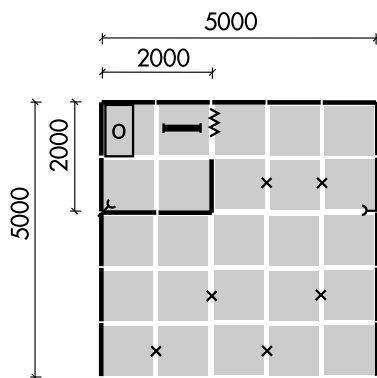

typ F

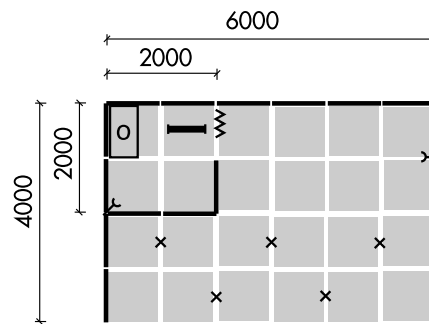

typ G

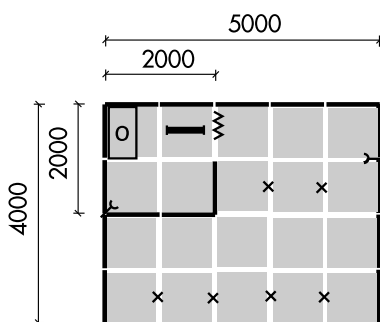

typ H

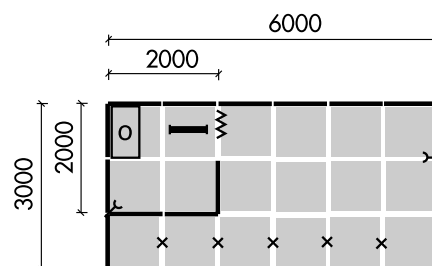

--- shield

—(socket

○ socket

× spot light

—| ceiling panel - light

7

Company: _____

Hall no. _____ Sector _____ Stand no. _____

We definitely order the basic construction of an individually designed stand the dimensions of which are _____ m x _____ m according to the layout drawn on the reverse side of this order.

The basic construction contains: 2-3 circumferential walls, ceiling raster, shield of the height of 30 cm on the front part.

The price of the basic construction is EUR 30.- per 1m² to 30 m² (included) and EUR 25.- per 1m² above 30 m².

Over the limit of the basic construction we order the following additional items of the assembly system:

Item	EUR/piece	Number
wall panel, white 100 x 250	8	_____
graphic panel, 100 x 250 (it is possible to stick items on it)	12	_____
wall glass, 100 x 250	14	_____
wing door	43	_____
rolling door	32	_____
curtain (EUR for 1 linear metre)	3	_____
carpet, grey (EUR for 1 m ²)	6	_____
carpet, of another colour (EUR for 1 m ²), specify colour _____	7	_____
shield, height 30 cm (EUR for 1 linear metre)	2	_____
lower ceiling, white (EUR for 1 m ²)	7	_____
lower ceiling, of textiles (EUR for 1 m ²)	2	_____
lower ceiling, of a grid type (EUR for 1 m ²)	9	_____
illuminating lower ceiling, fluorescent lamp type (EUR for 1 m ²)	10	_____
display case, glassed 100 x 100 x 250 with illumination	50	_____
display case, glassed 100 x 50 x 250 with illumination	40	_____
cupboard with five shelves, (mounted into the stand structure)	18	_____
point lighting fitting 60 - 100 W	4	_____
halogen spotlight 300 W	5	_____
halogen spotlight 500 W	5	_____
triple power socket	2	_____
self-standing panel 100 x 250 (with base 100 x 50 x 50 and with a collar 100 x 30)	30	_____

We require that the stand should be equipped with movables

In the case of YES, please fill in: Order of movables and other equipment.

place, date _____

_____ stamp, signature

Closing date for orders is July 31, 2004

Note: The order is not valid unless the place, date, seal and signature are filled in

Please, draw in the following raster your draft ground plan of the stand. Use the signs described below for the identification of the location of independent constructional items and equipment.



- | | | | | |
|-------------------------|------------------|-----------------------------|--------------|--------|
| wall panel | counter showcase | socket 220 V | chair | cooker |
| gr. panel | elevator | socket 220 V (night) | wall glass | |
| rolling doors | shield | distributor (dep. on needs) | shelf | |
| ceiling raster | fl. lamp | table | kitchen sink | |
| showcase (incl. illum.) | spot light | round table | refrigerator | |

8

Company: _____

Hall no. _____ Sector _____ Stand no. _____

We definitely order the construction of an assembled stand ("montistand") for the outdoor area including the architectural solution according to the layout drawn on the reverse side of this order, with the basic dimensions:

- 3 x 3 m (roof dimension 4 x 4 m - it cannot exceed the dimensions of the area ordered)
at the basic price of **EUR 665.-** **YES** **NO**

- 4 x 4 m (roof dimension 5 x 5 m - it cannot exceed the dimensions of the area ordered)
at the basic price of **EUR 1215.-** **YES** **NO**

The construction includes: platform (12 cm), grey carpet, circumferential walls (possibly wall glass) and door, roof including the ceiling structure, ceiling raster including the ceiling fillers, ceiling illumination and a power supply socket. The power supply inlet is to be ordered separately as it is not included in the price.

Any enlargement of the assembled stand is only possible in modules of 3 x 3 or 4 x 4 and in such a case each m² of the area will be charged at EUR 75.-

We definitely order a construction of the enlarged assembled stand ("montistand") the total dimensions of which are:

_____ m x _____ m

We require movables equipment

In the case of YES, please fill in: Order of movables and other equipment.

We enclosure the location of our montistand in the frame of complete ordered outdoor area:

place, date _____

_____ stamp, signature

Note: The order is not valid unless the place, date, seal and signature are filled in

Please, draw in the following raster your draft ground plan of the stand. Use the signs described below for the identification of the location of independent constructional items and equipment.



- | | | | | |
|-------------------------|------------------|-----------------------------|-----------------------|--------|
| wall panel | counter showcase | socket 220 V | chair | cooker |
| gr. panel | elevator | socket 220 V (night) | wall glass | |
| rolling doors | shield | distributor (dep. on needs) | cupboard with shelves | |
| ceiling raster | fl. lamp | table | kitchen sink | |
| showcase (incl. illum.) | spot light | round table | refrigerator | |

9

Company: _____

Hall no. _____ Sector _____ Stand no. _____

We definitely order the following movables and additional equipment of the stand:

Item	EUR/piece	Number
table 70 x 120 x 75	10	_____
table 70 x 70 x 75	10	_____
round table - diameter 80	10	_____
revolving chair	6	_____
upholstered chair	5	_____
plastic chair	2	_____
bar chair	7	_____
refrigerator 175 l	28	_____
stand-type hanger	3	_____
wall-type hanger	5	_____
raising desk, covered, with a shelf of 100 x 100 x 80, poss. 110	15	_____
raising desk, covered, with a shelf of 100 x 50 x 80, poss. 110	14	_____
display case, desk-type 100 x 50 x 80	30	_____
lockable case 70 x 40 x 130	10	_____
lockable case 80 x 40 x 80	7	_____
litter bin	2	_____
holder of folders, wired	6	_____
holder of folders, wired, type "A"	5	_____
wall shelf 100 x 30	5	_____
point lighting fitting 60 - 100 W	4	_____
halogen spotlight 300 W	5	_____
halogen spotlight 500 W	5	_____
triple power socket	2	_____
kitchen cupboard with shelves (self-standing)	12	_____
kitchen cabinet, to be hung up	10	_____
kitchen cabinet, with a sink and water heater	43	_____
kitchen set, with a sink, water heater, small refrigerator and cooker	130	_____
coffee maker (power input 1.5 kW)	6	_____
fast water heater (power input 2 kW)	6	_____
cooker (power input 2 kW)	5	_____

IMPORTANT: If you order only the movables, without any construction of a stand, you will be invoiced 50% surcharge to the above specified prices

Deadline for orders is July 31, 2004

place, date _____

_____ stamp, signature

12

Company: _____

Hall no. _____ Sector _____ Stand no. _____

For the shield of the height of 30 cm we order the production of :

company's logo **YES** **NO**

company's name **YES** **NO**

Specify your idea and colour of the foil (attach colour background) for the logo and text on the shield:

Backgrounds for logo and name of your company or for the production of the graphic pane should be sent BY REGISTERED MAIL.

We attach our backgrounds to number of _____ enclosures

place, date _____

_____ *stamp, signature*

The price will be specified individually according to the number of colours, extension or number of letters.

Deadline for order is July 31, 2004

Note: The order is not valid unless the place, date, seal and signature are filled in

Type Stands of the SYMA - ORBIT System

The type stands include: external walls made of white panels (colour design - individual order according to an agreement) ● eye-catcher ● carpet ● 2-6 spot lights (without power supply inlet) according to the stand size ● 2 power sockets for 220 V (without power supply inlet) ● furniture: show cases, tables, office equipment - special calculation



type 1

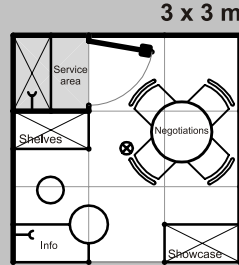

type 2

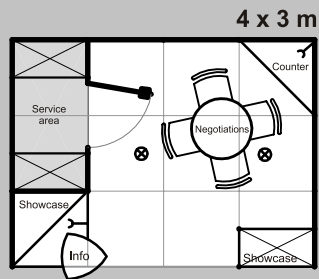

type 3

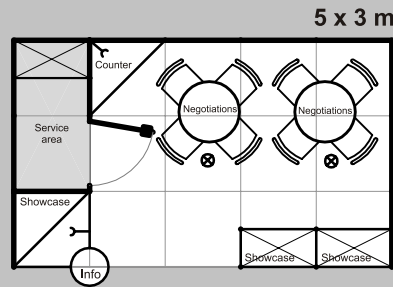

type 4

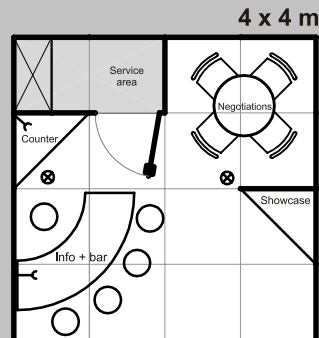

Legend:



11a

Type Stands of the SYMA - ORBIT System

The type stands include: external walls made of white panels (colour design - individual order according to an agreement) ● eye-catcher ● carpet ● 2-6 spot lights (without power supply inlet) according to the stand size ● 2 power sockets for 220 V (without power supply inlet) ● furniture: show cases, tables, office equipment - special calculation



type 5

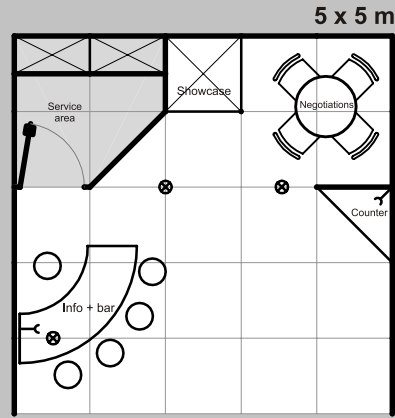
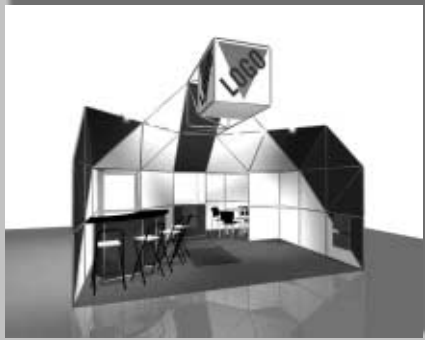

type 6

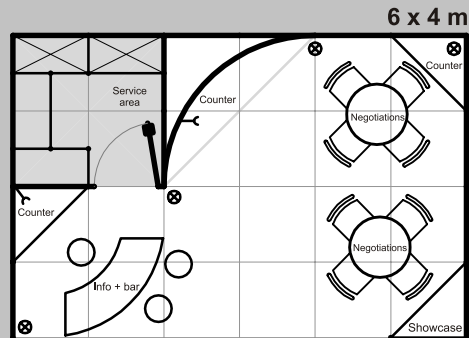

type 7

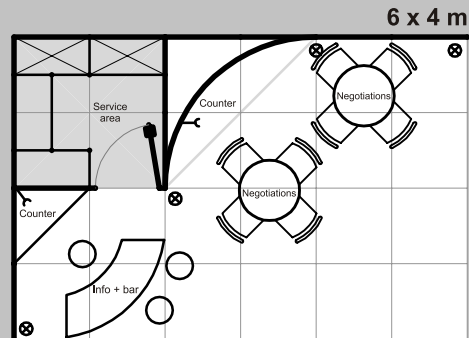

type 8

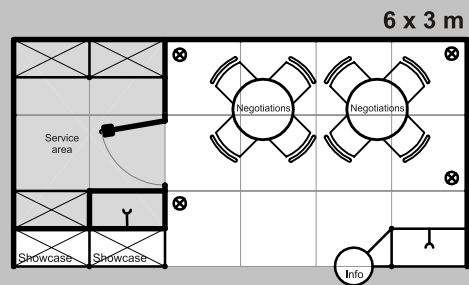

Legend:



Type Stands of the SYMA - ORBIT System

The type stands include: external walls made of white panels (colour design - individual order according to an agreement) ● eye-catcher ● carpet ● 2-6 spot lights (without power supply inlet) according to the stand size ● 2 power sockets for 220 V (without power supply inlet) ● furniture: show cases, tables, office equipment - special calculation



Price list

The type stands cannot be modified from their design.

The basic construction equipment of the type stands cannot be changed or complemented, but it is possible to order furniture and additional equipment.

Type stand prices:

Type no.	Surface area (m ²)	Area type	Stand height (m)	Price (EUR without VAT)
1	9	row	3	372
2	12	row	4	531
3	15	row	4	663
4	16	row	4	707
5	25	row	4	913
6	24	row	4	1,188
7	24	corner	4	1,000
8	18	row	4	891

Order

Company:

We bindingly order implementation of the stand, type (1 - 8).

We require equipment with furniture (Yes/No).

If YES, please fill in the form "Order of furniture and additional equipment".

All prices are stated without VAT and shall apply to the Fairs and Exhibitions organised in Prague.

Please send the Exposition Implementation Order together with the Binding Application.

Note: The Order is invalid if you do not fill in the place, date, stamp and signature.

Place, date

Stamp, signature

Type Stands of the SYMA - ORBIT System

The type stands include: external walls made of white panels (colour design - individual order according to an agreement) ● eye-catcher ● carpet ● 2-6 spot lights (without power supply inlet) according to the stand size ● 2 power sockets for 220 V (without power supply inlet) ● furniture: show cases, tables, office equipment - special calculation



Order of furniture and additional equipment

Order of furniture:

1. Coating of filling areas with a colour foil, according to the choice: 15 EUR/m²
2. Show case 100 x 100 x 50 cm: 49 EUR/unit
3. Table: 10 EUR/unit
4. Chair: 6 EUR/unit
5. Bar chair: 8 EUR/unit
6. Information table: 10 EUR/unit
7. Kitchen set (refrigerator, kitchen sink, water heater, two-top cooking stove): 113 EUR/unit
8. Wire rack 180 x 80 x 40 cm: 30 EUR/unit
9. Atypical information counter, beech design: 113 EUR/unit
10. Production of logos, descriptions, etc. - by way of agreement

We order the following equipment:

.....

.....

.....

.....

.....

.....

.....

.....

_____ Place, date

_____ Stamp, signature